

SUGAR DISSOLVER (CAP: 1000- 6000 LTR)

MOC

INNER SHELL: 2 / 3 MM SS 304

OUTER JACKET: 2 MM SS 304

DIMPLE JACKET: 1.6 MM SS 304

TOP LOOSE COVER: 2 MM SS 304

NOTE- CAN ALSO BE SUPPLIED WITH SS 316

TECHNICAL DATA

	INNER SHELL PRESSURE (BAR)	DIMPLE JACKET PRESSURE (BAR)
TEST	ATM	6 (MAX)
WORK	ATM	4 (MAX)

INSULATION

CAPACITY (LTR)	TYPE	THICKNESS (MM)
1000	ROCK WOOL	75
2000	ROCK WOOL	100
3000	ROCK WOOL	100
4000	ROCK WOOL	100
5000	ROCK WOOL	100
6000	ROCK WOOL	100

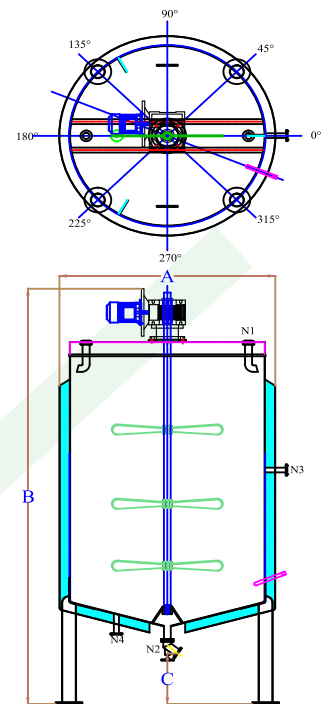

NOZZLES & ACCESSORIES

PRODUCT INLET	38 / 51 MM	SMS UNION
PRODUCT OUTLET	38 / 51 MM	SMS UNION
STEAM / HOT WATER INLET	25 / 38 NB	FLANGE
CONDENSATE / HOT WATER OUTLET	25 NB	FLANGE

N1- PRODUCT INLET
N2- PRODUCT OUTLET
N3- STEAM INLET
N4- COND. OUTLET

AGITATOR , MOTOR DATA

OVER ALL DIMENSIONS (MM)

CAPACITY (LTR)	MOTOR POWER (HP)	GEAR BOX MODEL	AGITATOR SPEED (RPM)	A	B	C	SHELL -ID	SHELL -HEIGHT	NO. OF LEGS
1000	2	ALM-90	90	1260	2460	400	1100	1200	4
2000	3	ALM-110	90	1560	2815	400	1400	1500	4
3000	5	ALM-110	90	1610	3355	400	1450	2000	4
4000	5	ALM-110	90	1810	3385	400	1650	2000	4
5000	7.5	ALM-110	90	2010	3387	400	1800	2000	4
6000	7.5	ALM-110	90	2010	3787	400	1800	2400	4

OPTIONS

★ CAN ALSO BE SUPPLIED WITH -

- 1-DISH END BOTTOM.
- 2-CONICAL TOP / DISH END WITH MAN HOLE.

★ SPEED OF AGITATOR CAN ALSO CHANGE IF REQUIRED BY PROCESS CONDITIONS.

ADDITIONAL ACCESSORIES

- ★ LEVEL INDICATOR / SENSOR.
- ★ TEMPERATURE INDICATOR AND SENSORS.